

Install the accessories on the bowl

- 1: Fit the plunger on the cross piece, then screw the flexible to the plunger (seal enclosed).
- 2: Pass the hose under the control panel support.
- 3: Assemble the nozzle, then screw the flexible fitting from the plunger to the nozzle (seal supplied).
- 4: Assemble the pre-mixer on the plunger (seal supplied), hot water on the left.
- NB: remember to fit the flat filter seals (supplied).**
- 5: Assemble the plug hole and trap.
- 6: Adjust the temperature of the water.

FIXING THE WASH BASIN:

The two models of wash basin have the same fixing system.

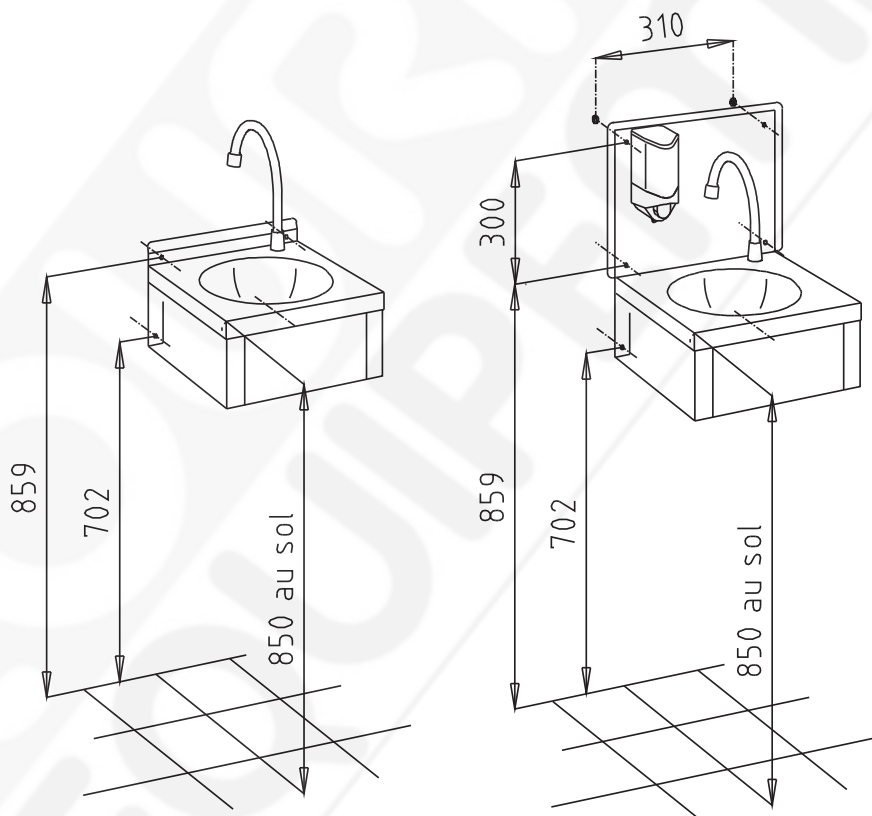

- 1: Approach the wash basin and mark out the location of the plugs on the wall.
- 2: Drill and insert the plugs (not supplied) making sure they are held in the wall.
- 3: Fix the wash basin using stainless steel screws (not supplied). For wash basins with a splash back, insert the plastic washers between the splash back and the wall for the 2 upper screws.
- 4: Stick on the soap dispenser using the double-sided tape supplied and store the key in the location provided on the valve support.
- 5: Connect the trap to the drain and the hot and cold water supply to the mixer.